

MMDA PLAN NO. /
 CN. A/15801/89.
 Asst.
 Scrut. y
 PART I 05/09/90
 PART II
 9/11/90
 A.P. D.P.

Planning Permit No. A/539/90
APPROVED
 SUBJECT TO THE CONDITIONS IN
 THIS OFFICE LETTER.
 No. A/15801/89 Date 3-5-90
 o/c C. R. Vimala 3/5/90
 FOR MEMBER SECRETARY
 MADRAS METROPOLITAN
 DEVELOPMENT AUTHORITY
 MADRAS - 600 008

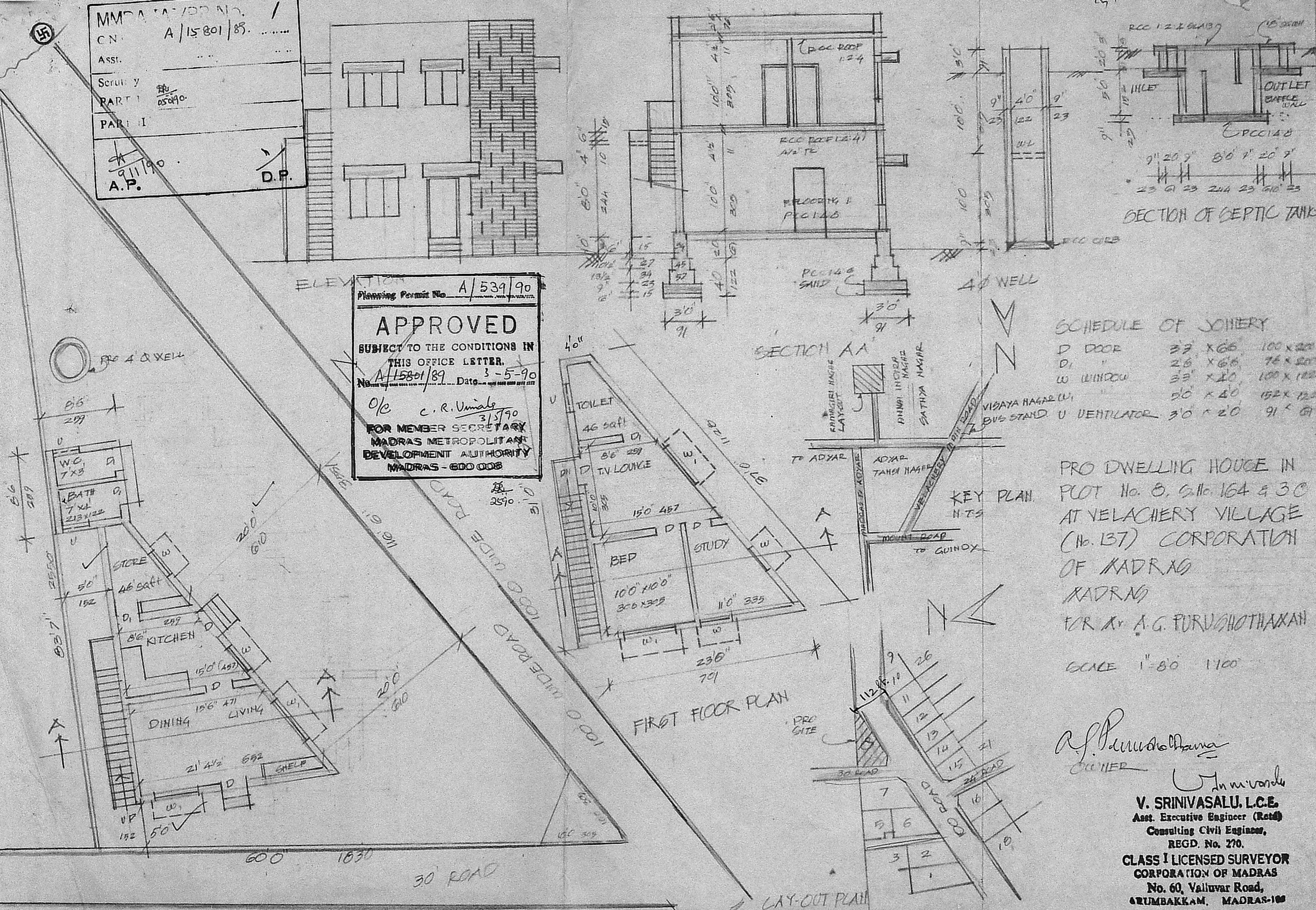

SCHEDULE OF JOINERY

D DOOR	32' x 66"	100 x 200
D ₁	26' x 66"	76 x 200
W WINDOW	33' x 20"	100 x 100
	50' x 40"	152 x 120
U VENTILATOR	30' x 20"	91 x 61

PRO DWELLING HOUSE IN
 PLOT No. B, S.No. 164 & 30
 AT VELACHERY VILLAGE
 (No. 137) CORPORATION
 OF MADRAS
 MADRAS
 FOR Mr. A. G. PURUSHOTHAMAN
 SCALE 1" = 80' 1/100

A. P. Srinivasulu
 OWNER
 V. Srinivasulu
 V. SRINIVASULU, L.C.E.
 Asst. Executive Engineer (Retd)
 Consulting Civil Engineer,
 REGD. No. 270.
 CLASS I LICENSED SURVEYOR
 CORPORATION OF MADRAS
 No. 60, Valluvar Road,
 GRUMBAKKAM, MADRAS-100